

---

# **INFORMATION ITEM:**

## **Construction Projects**

**Dr. Alan Robertson**  
**Vice President for Finance and Administration / CFO**

# Major Capital Projects Update

---

- ❖ **Center for Access and Student Success (CASS)**
- ❖ **700 Bed Residence Hall**
- ❖ **Central Energy Plant (CEP)**
- ❖ **FAMU Student Service Center Dining Hub**
- ❖ **Student Amphitheater**



# Center for Access and Student Success (CASS)

---





# Center for Access and Student Success (CASS)

<b>Project Status Report:</b>	<b>Budget: \$41,000,000</b>	<b>Date: 4/28/2020</b>
-------------------------------	-----------------------------	------------------------

<b>Project #:</b>	<b>Project Name:</b>	<b>University Project Manager:</b>	<b>Project Status:</b>
BRFM 337	Center for Access and Student Success	David Rosenfeld/Craig Talton	
<b>Design Status (% Complete):</b>	<b>Designer:</b>	<b>Substantial Completion Date:</b>	
100%	JRA Architects	August 10, 2020	
<b>Construction Status (% Complete):</b>	<b>Contractor:</b>	<b>Occupancy Date:</b>	
60%	Ajax Construction	September 10, 2020	
<b>Timely Completion Risk: COVID-19</b>			
<b>Mitigation Strategy: Contractors Following State &amp; Federal Guidelines</b>			
<b>Project Contracts:</b>	<b>Expenses:</b>	<b>Encumbrances:</b>	<b>Remaining:</b>
\$41,000,000	\$17,783,950	\$22,777,673.45	\$438,376.30



# 700 Bed Residence Hall

---





# 700 Bed Residence Hall

Project Status Report:		Budget: \$59,500,000*	Date: 4/28/2020	
Project #:	Project Name:	University Project Manager:	<b>Project Status:</b>  <b>On Time</b>	
BRFM 343	700 Bed Residence Hall	David Rosenfeld/Craig Talton		
Design Status (% Complete):	Designer:	Substantial Completion Date:		
100%	Finrock Design Inc.	July 27, 2020		
Construction Status (% Complete):	Contractor:	Occupancy Date:		
85%	Construct Two Group (CTG)	August 11, 2020		
Timely Completion Risk:		Completion of the Central Energy Plant by April 25 <sup>th</sup>		
Mitigation Strategy:		A temporary chiller and boiler will be utilized.		
Project Contracts:	Expenses:	Encumbrances:	Remaining:	
\$56,635,386	\$43,295,508	\$12,841,021	\$498,857	

**\*Note: An additional \$1M was approved for the residence hall budget during the December BOT Meeting.**



# Central Energy Plant (CEP)





# Central Energy Plant (CEP)

Project Status Report:		Budget: \$3,363,348*	Date: 4/28/2020	
Project #:	Project Name:	University Project Manager:	<b>Project Status:</b>  <b>Weather Delay</b>	
BRFM 343	Central Energy Plant	David Rosenfeld		
Design Status (% Complete):	Designer:	Substantial Completion Date:		
100%	Pinnacle Engineering Group	March 30, 2020		
Construction Status (% Complete):	Contractor:	Occupancy Date:		
98%	Lang Mechanical Inc.	April 30, 2020		
Timely Completion Risk:		Severe weather		
Mitigation Strategy:		Temporary chiller and boiler will be in place until the CEP is completed.		
Project Contracts:	Expenses:	Encumbrances:	Remaining:	
\$3,364,614	\$2,859,567	\$529,653	0	

**\*Note: An additional \$1M was approved for the CEP budget during the December BOT Meeting.**



# FAMU Student Service Center Dining Hub

---





# FAMU Student Service Center Dining Hub

Project Status Report:		Budget: \$9,300,000*		Date: 4/28/2020	
Project #:	Project Name:	University Project Manager:	<b>Project Status:</b>  <b>Weather Delay</b>		
BRFM 343	Student Dining Facility	Elston Peets			
Design Status (% Complete):	Designer:	Substantial Completion Date:			
100%	Andy Share and Associates	Oct 30, 2020			
Construction Status (% Complete):	Contractor:	Occupancy Date:			
6%	CTG/Genterra	Nov 30, 2020			
Timely Completion Risk:		Severe weather, equipment delivery, COVID-19.			
Mitigation Strategy:		Developer will work with Auxiliary Services, Metz and Genterra weekly to reduce the risk associated with long lead time equipment.			
Project Contracts:	Expenses:	Encumbrances:	Remaining:		
\$9,269,230	\$289,250	\$5,106,870	\$1,103,880		

**\*Note: An additional \$5M was approved for the dining hub budget during the December BOT Meeting.**



# FAMU Student Amphitheater

---

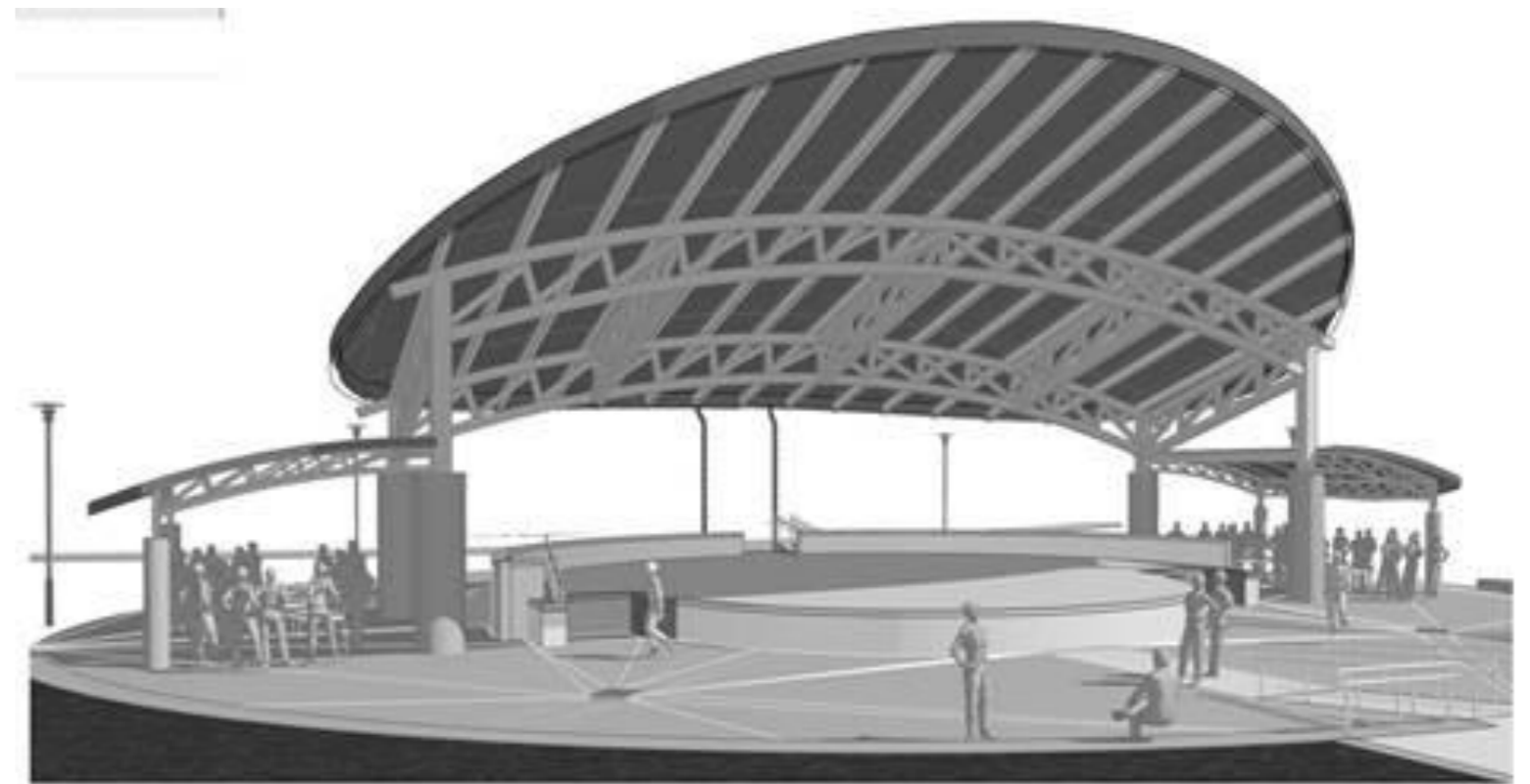



# FAMU Student Amphitheater

Project Status Report:		Budget: \$2,727,934*		Date: 4/28/2020	
Project #:	Project Name:	University Project Manager:	<b>Project Status:</b>   <b>On Time</b>		
CITF 2019	Student Amphitheater	David Rosenfeld			
Design Status (% Complete):	Designer:	Substantial Completion Date:			
100%	GRC Architects	Aug, 2020			
Construction Status (% Complete):	Contractor:	Occupancy Date:			
90%	RAM Construction	Sep, 2020			
Timely Completion Risk:		Severe weather (impact will be minimal)			
Mitigation Strategy:		None			
Project Contracts:	Expenses:	Encumbrances:	Remaining:		
\$2,227,934	\$1,516,624	\$165,483	\$90,605		

\*Note: \$500,000 has been added to the project budget, from the FAMU Foundation to add a canopy to the amphitheater.



---

# **INFORMATION ITEM:**

## **Potential COVID-19 Impacts**

### **a. CARES Act**

**Dr. Alan Robertson**  
**Vice President for Finance and Administration / CFO**

# CARES Act

	Summer 2020	
	5% reduction	10% reduction
Potential drop in Tuition Revenue due to drop in enrollment	\$ 335,713	\$ 671,426
Potential loss in fees (Parking, Health, Athletic, Activity & Service, Technology, Other Student Fees):	127,940	215,456
<b>SUB-TOTAL POTENTIAL LOSS OF TUITION AND FEES</b>	<b>463,653</b>	<b>886,882</b>
Other Auxiliary Estimated Revenue Loss	786,894	1,573,788
<b>ADDITIONAL COVID-19 FINANCIAL IMPACTS</b>		
Housing Refunds issued for Spring 2020 term (provided mid-April):	2,485,226	2,485,226
Housing Revenue losses for Summer 2020	2,226,538	2,226,538
Meal Plan Refunds/Credits issued for Spring 2020 term (provided mid-April):	1,795,514	1,795,514
Meal Plan and Other lost Food Sales Commissions	158,235	158,235
Other Expenses Incurred (cleaning, international travel returns, etc) Spring 2020	1,225,419	1,225,419
Other Expenses Incurred (cleaning, international travel returns, etc) Summer 2020	1,515,000	1,515,000
Requirement to pay for expanded Paid Sick & Family Leave:	1,936,595	1,936,595
<b>SUB- TOTAL ADDITIONAL COVID-19 FINANCIAL IMPACTS</b>	<b>11,342,527</b>	<b>11,342,527</b>
<b>GRAND TOTAL</b>	<b>\$ 12,593,074</b>	<b>\$ 13,803,197</b>



---

# **INFORMATION ITEM:**

## **Potential COVID-19 Impacts**

### **b. Budget Implications**

**Dr. Alan Robertson**  
**Vice President for Finance and Administration / CFO**

# Budget Implications FY20-21

	Fall/Spring 2020-2021	
	5% reduction	10% reduction
Potential drop in Tuition Revenue due to drop in enrollment:	\$ 2,814,334	\$ 5,628,668
Potential loss in fees (Parking, Health, Athletic, Activity & Service, Technology, Other Student Fees):	567,128	1,134,256
<b>SUB-TOTAL POTENTIAL LOSS OF TUITION AND FEES</b>	<b>3,381,462</b>	<b>6,762,924</b>
Housing Revenue losses for Fall/Spring 2020-2021	937,025	1,874,050
Meal Plan and Other lost Food Sales Commissions	42,504	85,008
Other Auxiliary Estimated Revenue Loss for Fall/Spring 2020-2021	1,236,226	2,472,452
<b>SUB-TOTAL POTENTIAL AUXILIARY REVENUE LOSS</b>	<b>2,215,755</b>	<b>4,431,510</b>
<b>GRAND-TOTAL</b>	<b>\$ 5,597,217</b>	<b>\$ 11,194,434</b>





***“At FAMU, Great Things are Happening Every Day!”***